

TUBES

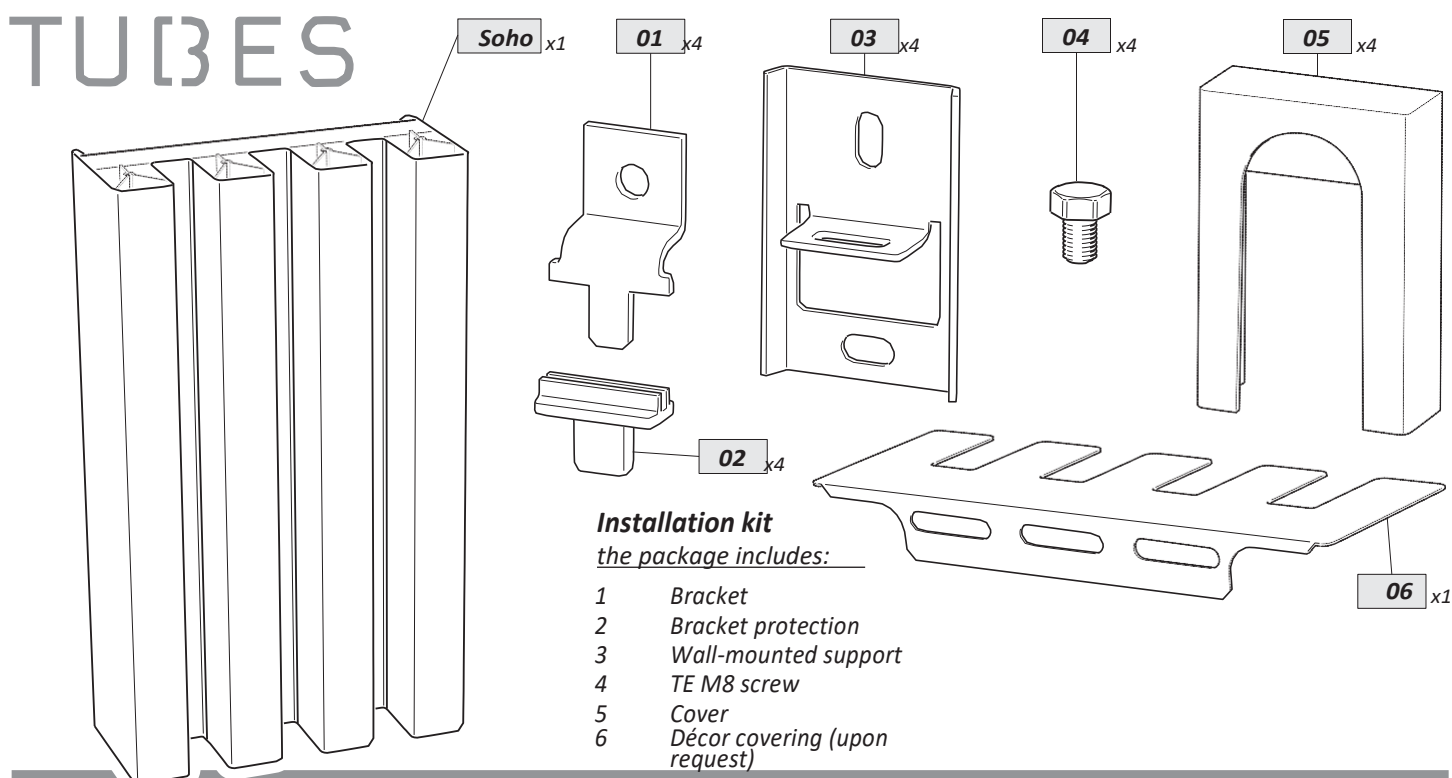

Insert the protections (02) onto the 4 brackets (01). Secure to the radiator the two upper brackets (01) using screws 04, all the way to the mechanical stop.

Phase 1

Screw in without locking the other 2 lower brackets as shown in fig. 1.1.

Once you have identified the place of installation of the radiator, mark the fixing holes for the supports (03), considering the dimension specified in fig.1.2, and placing them at distance A depending on the number of elements (see Tab. 1). Maximum height B measured on the radiator see fig. 1.3.

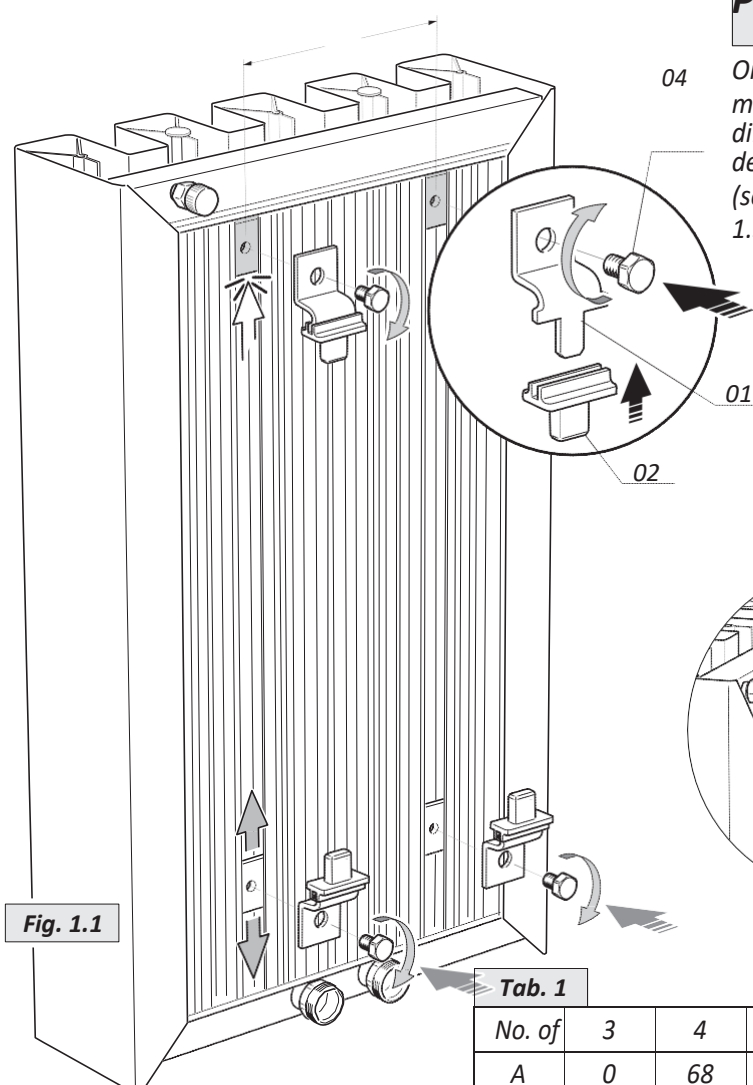

Fig. 1.1

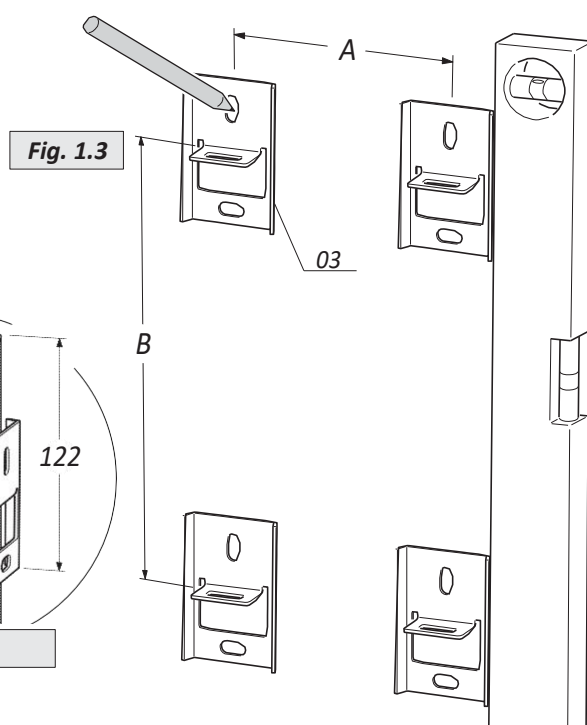

Fig. 1.3

Tab. 1

No. of	3	4	5	6	7	8	9	10	11	12
A	0	68	136	204	272	340	408	476	544	612

Measurements are expressed in mm

Secure the supports (03) using screws and dowels that are suitable for the type of wall, as shown in fig 2.1

Phase 2

Fig. 2.1

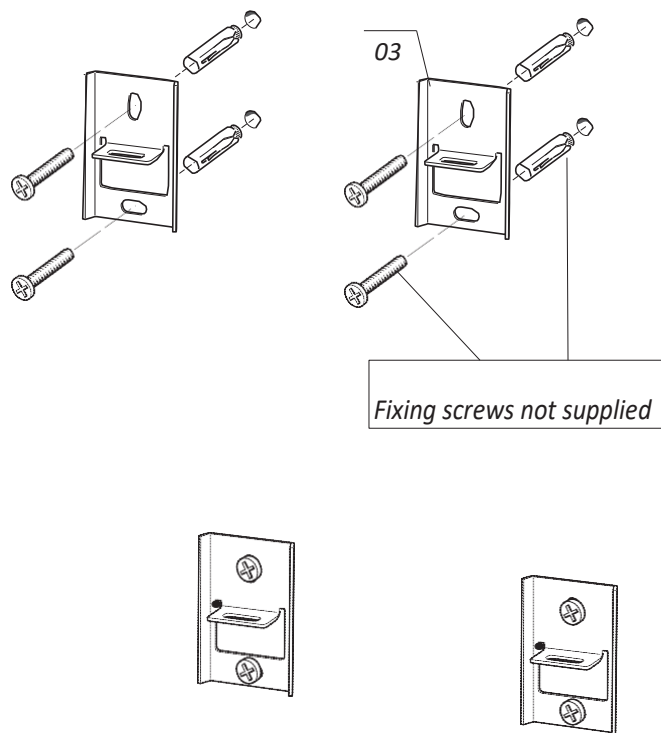

Phase 3

Hang the Soho radiator in place inserting the brackets (01) into the upper supports (03), see fig. 3.1.

Fig. 3.1

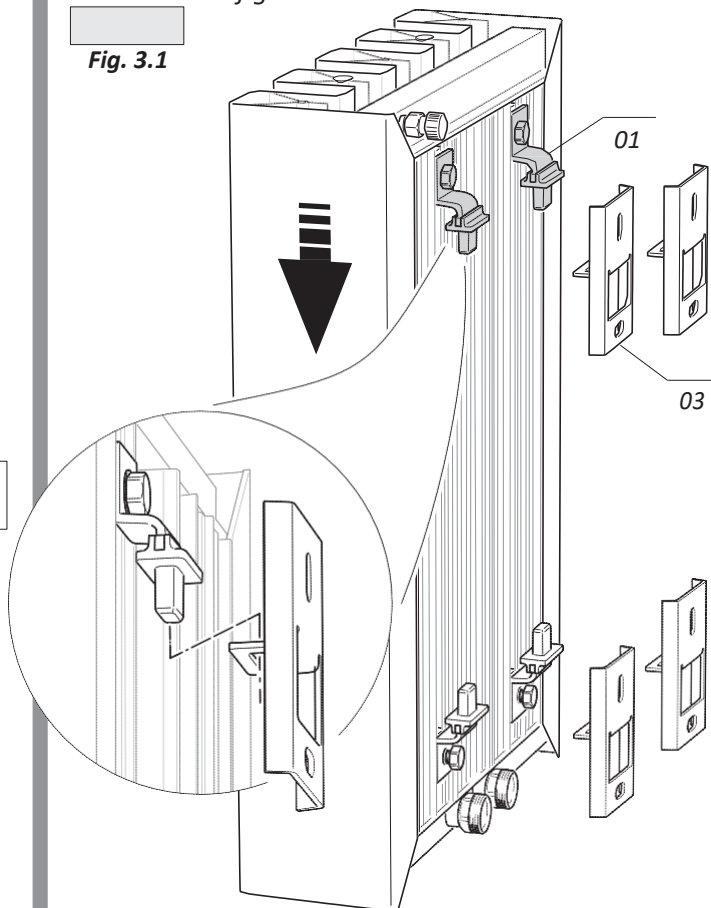

Phase 4

Make the hydraulic connections shown in fig. 4.1, following the remote valve assembly diagram.

Fig. 4.1

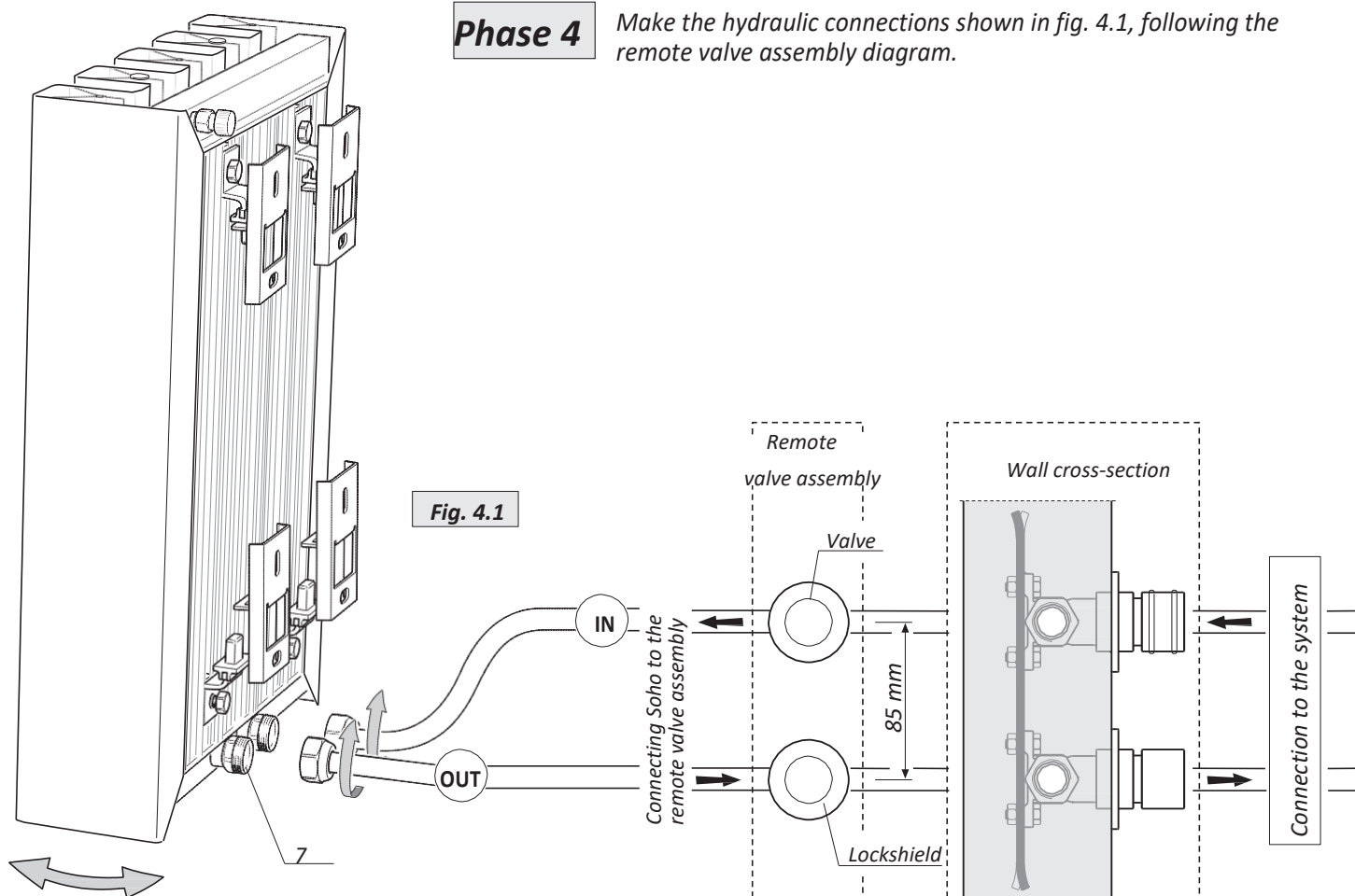

Phase 5

Insert the brackets (01) into the lower supports (03) and secure them in place with the screws (04) as shown in fig. 5.1. Apply covers 05 to brackets 03 inserting them from the top (Fig. 5.2).

Fig. 5.1

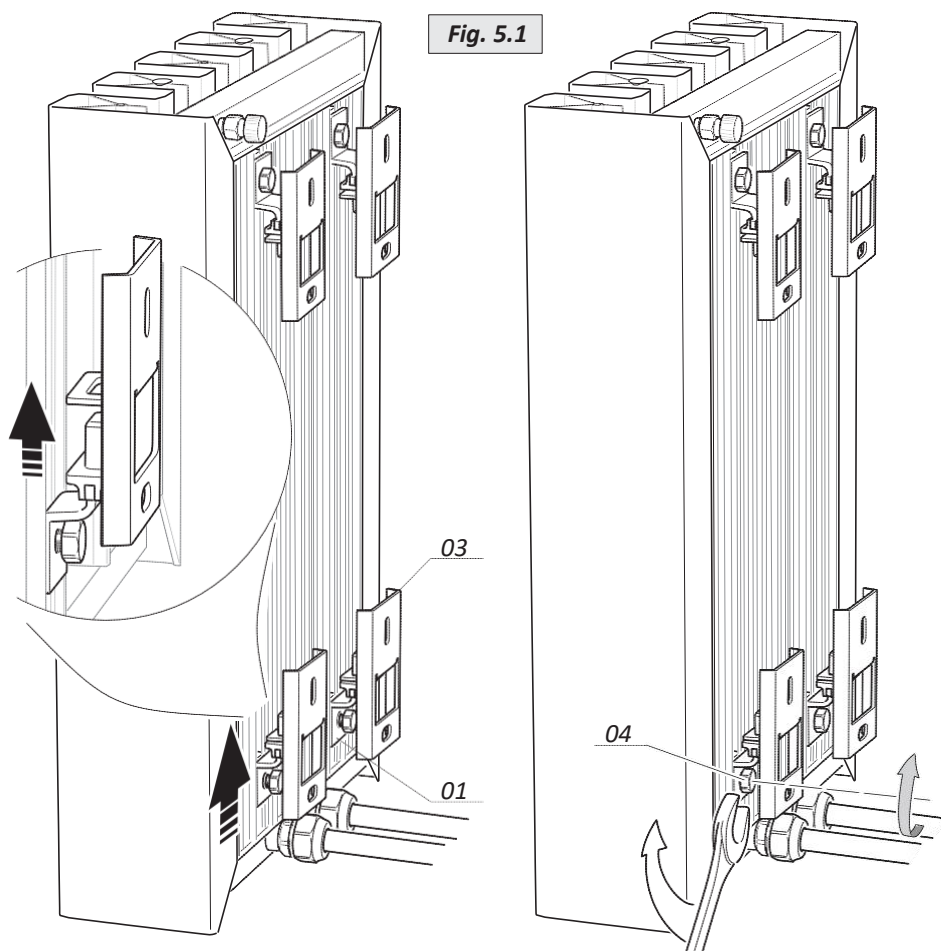
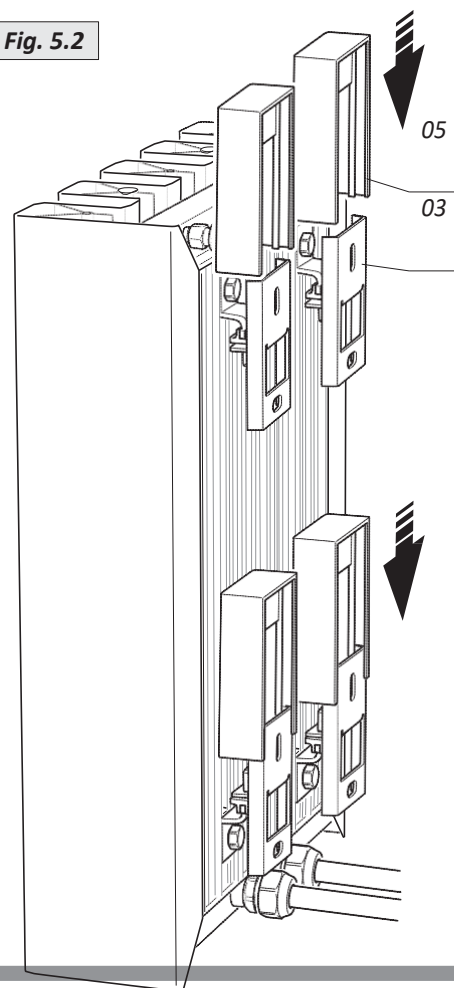

Fig. 5.2



Phase 6

For models supplied with a décor covering (05) apply the latter to the radiator as shown in fig. 6.1.

Fig. 6.1

