

Specifications

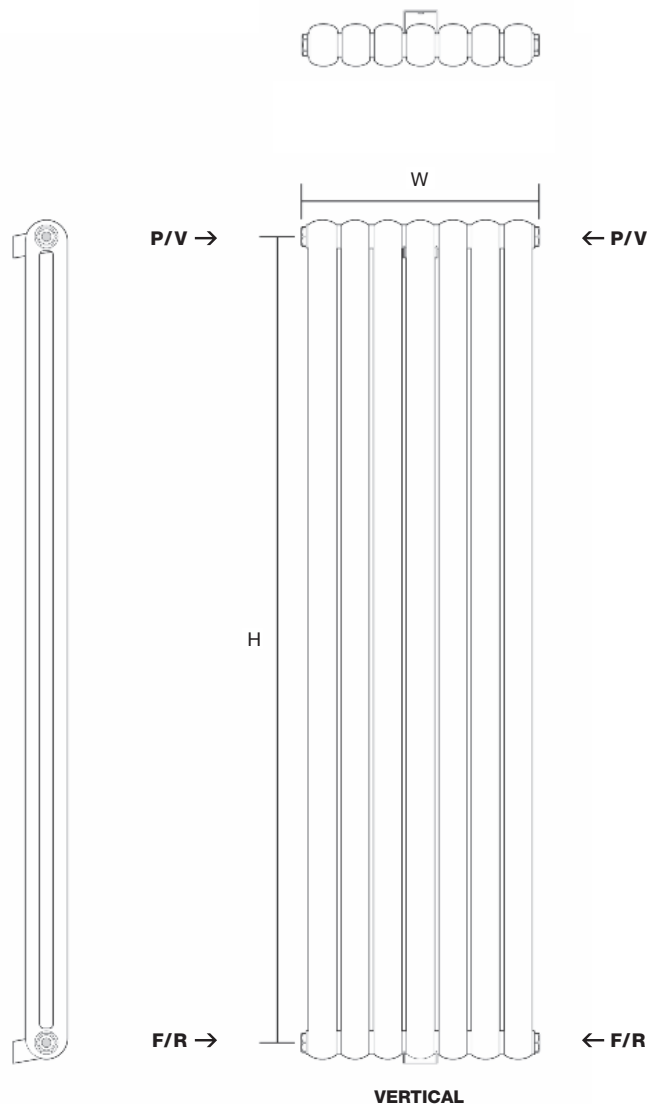

Technical Information

Standard connections: ½"

F = Flow **R** = Return

P = Plug **V** = Vent

Pipe centres:

Vertical = radiator width + valves

Wall to front face = 115mm

Wall to pipe centre = 70mm

Technical Specifications

Materials: Mild Steel

Connections: ½" Flow and Return

Test pressure: 8 Bar

Testing authority: EN442

Max operation pressure: 4 Bar

Max working temperature: 95c

These can be cleaned using a soft damp cloth with a non-abrasive cleaning product.



PLEASE NOTE: That in accordance with Part L1 2006 of the Building Regulations and BS7593:1992 code of practice for the treatment of hot water and central heating systems, we recommend flushing the heating system before installation of new radiators and then adding the correct quantity and type of inhibitor for use with the radiator and system to prevent corrosion. Damage caused to systems not protected by a suitable inhibitor will not be covered by the manufacturer warranty. It is the responsibility of the installer to ensure the correct use and suitability of the fixings provided. No liability for costs or damages arising from failure to do so can be accepted.

Content list & Tools required



Review instructions carefully before installation.
Installation should be completed by a suitably qualified person.
Please dispose of packaging in a responsible manner.

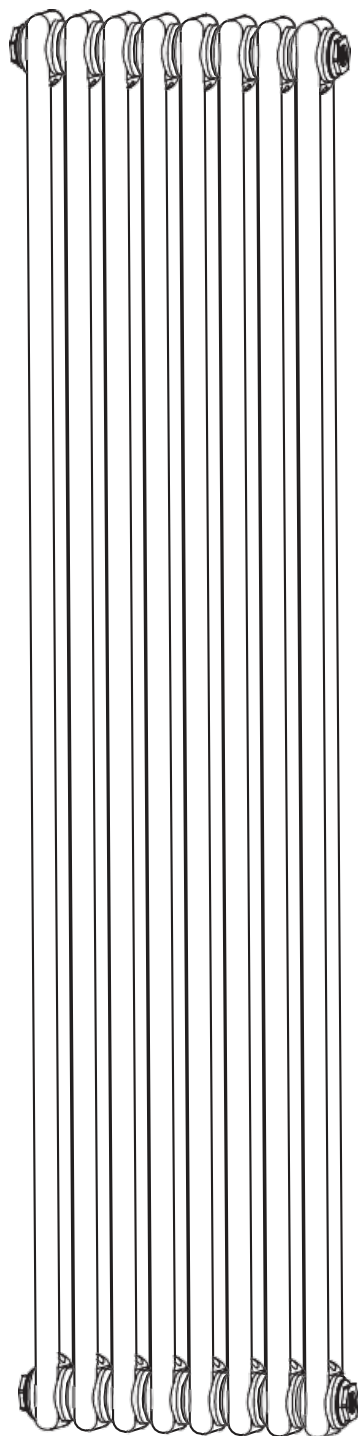

Contents list

Accessory for bars ≤ 22 (>22 bar)

Ref	Icon	Description	Qty
A		Spare Washer	1
B		Masonry Wall Plug	8 (12)
C		Screw	8 (12)
D		Air Vent	1
E		Blank Plug	1
F		Wall Bracket	4 (6)

Tools required

	Screwdriver
	Pencil
	Adjustable Wrench
	Rubber Hammer
	Glove
	Tape Measure
	PTFE Tape
	Spirit Level
	Electric Drill
	Clean Cloth



1. Follow installation instructions carefully to ensure unit is properly attached to the wall.
2. To avoid a possible fire hazard, it is essential unit is mounted in accordance with guidelines stated in the instruction.
3. Radiator is intended for indoor use only, do not place radiator inside a shower, steam room, or wherever unit would be exposed to water.
4. These radiators can be very heavy products it is recommended you consult a qualified person if you are unsure about the suitability of the wall they are to be mounted on to take the weight.

Technical Data

It should only be filled with water and at a temperature below 100°C(212°F). See table below for installation requirements. If the temperature exceeds 48°C (or 120°F), please install a warning sign near the product to avoid burning and scolding accidents.

Fill 3/4 Full: water only

Temperature: 0°C$t\leq 100^{\circ}\text{C}$

Comments: If ambient temperature drops below 1°C, drain out the water to prevent freezing.

Important: Wipe the surface clean with a soft, damp cloth. Never use abrasive cleaners on this product as they will damage the surface.

Important Child Safety Note

Important: Please note that you are 100% legally responsible for your own child's safety at home. Once the radiator is installed, it can become a hazard for children. This radiator is not designed to support unreasonable extra weight, such as that of a child, and the radiator becomes hot during use. Due to this, we must stress that you should not allow children to climb/grab/play with the radiator or rails, as this can cause accident or injury for the child from heat, falling or the radiator being pulled off the wall.

Before Installation

- Observe all local plumbing and building codes.
- Shut off the main water supply.
- Read these instructions carefully to ensure proper installation.
- Check to make sure you have the following parts indicated below.

Installation Instructions

- A** Position the radiator in desired location check for level and mark four equal positions for the brackets.



Before Installation place a dust sheet on the floor to prevent losing any small parts

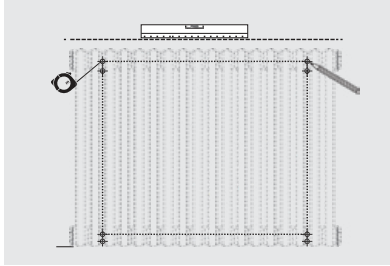

Allow enough room for the installation of valves and/or thermostatic controls

- B** Drill holes in wall and insert wall plugs. N.B For false or studed walls different fixings can be purchased from your local DIY store.

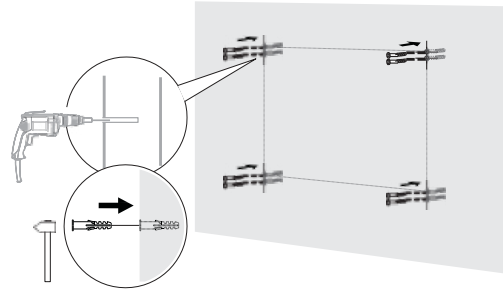

- C** Fix the wall brackets to the wall with screws provided and ensure a secure holding.

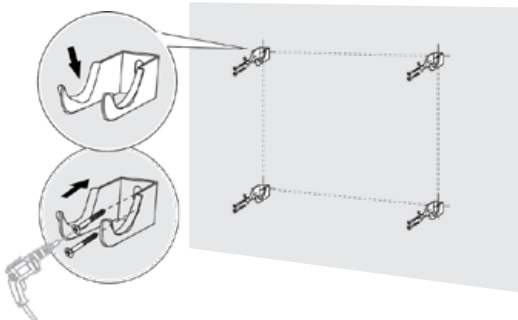

- D** Wrap PTFE tape around blanking plug and bleeder valve and screw into top of radiator tighten with a spanner.

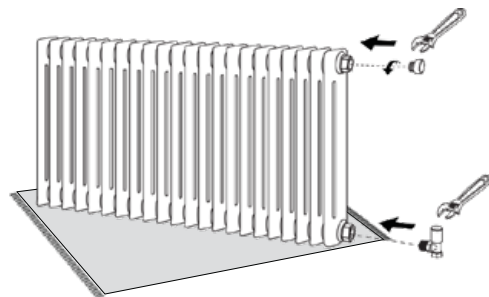

Apply PTFE tape to valves and screw into bottom of radiator tighten with a spanner.

- E** Rest radiator onto brackets and connect valves to household supply.

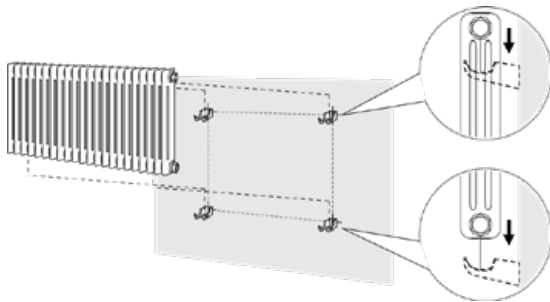

- F** Well Done

